



AB&R®

identify. track. manage.



CAUTION...BEFORE YOU PRINT

Ribbon may have dislodged in shipping!

If RED light turns on please make sure Notches are Aligned.

PREPARE RIBBON

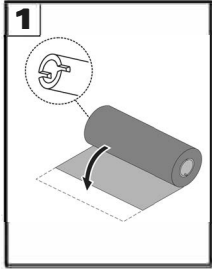

1
Pull Adhesive Strip Free

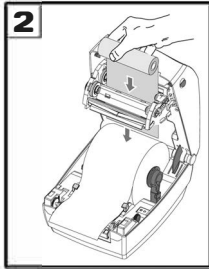

2
Thread Ribbon Through Carriage

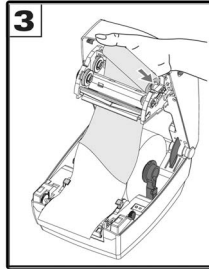

3
Press onto Hub

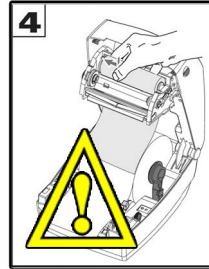

4
Align Notches onto Hub Spokes Leaving NO Gap

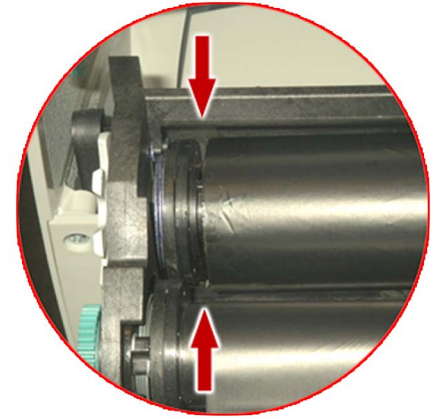

INCORRECT

INSTALL TAKE-UP CORE

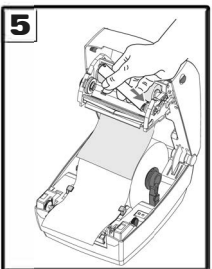

5
Press onto Hub

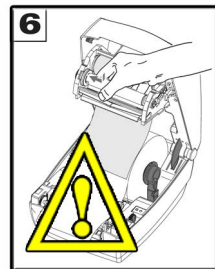

6
Align Notches onto Hub Spokes Leaving NO Gap

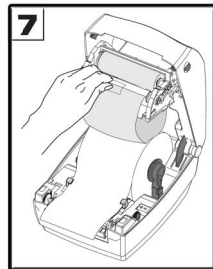

7
Attach Ribbon to Take-Up Core

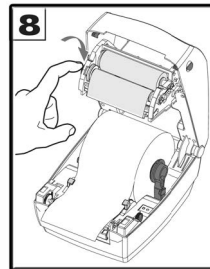

8
Remove Slack From Ribbon

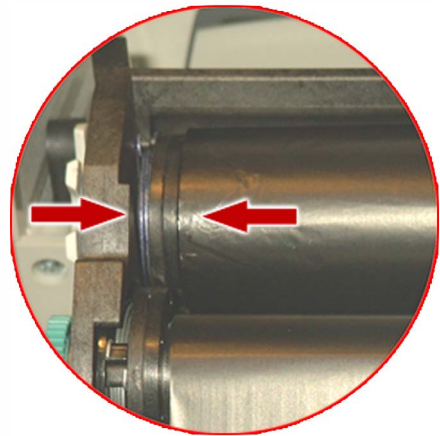

CORRECT

TIGHTEN RIBBON

TO PRINT:

1. Push the "FORM" button on your keyboard and choose the format number from the enclosed list for your desired label.
2. Enter answers to the prompted questions on the keyboard display.
3. Hit "Enter" after each question is answered.
4. Enter number of labels to print. (Quantity ONE is the default)
5. Hit "ENTER" again to print label.

